



# SERIE ISO TANDEM 3.1.2.6.

CODICE DI ORDINAZIONE - DECODING

3.1.2.6 . XXX . X . 0 . X . 0

DIN  
5 4 6 2  
SE

ISO 62  
ISO 73  
ISO 84  
ISO 100  
ISO 116  
ISO 132  
ISO 148

ALLESTIMENTI SPECIALI/SPECIAL OPTIONS  
1 = MONTAGGIO IN TANDEM/TANDEM FITTING  
8 = MONTAGGIO IN TANDEM E ALBERO SUPPORTATO  
TANDEM FITTING AND BEARING GEAR

ROTAZIONE/ROTATION  
1 = SINISTRO/ANTICLOCKWISE  
2 = DESTRO/CLOCKWISE

CILINDRATA/DISPLACEMENT

CODICE BASE/BASIC CODE

## Pompa ad Ingranaggi Gear Pump

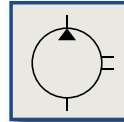
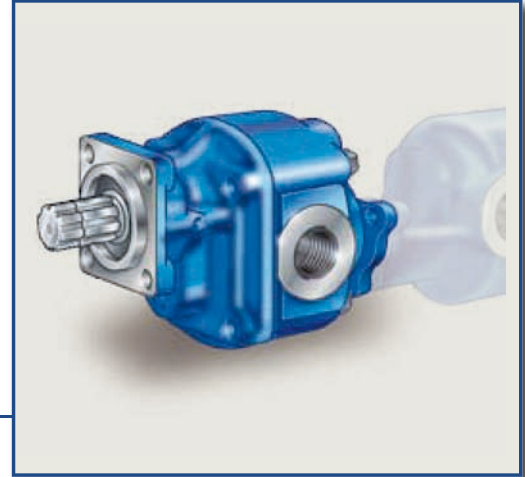

### CARATTERISTICHE E DATI TECNICI - SPECIFICATIONS AND TECHNICAL DATA

TIPO TYPE	CODICE CODE	CILINDRATA DISPLACEMENT cm <sup>3</sup> /rev.	A mm	B mm	C ASPIRAZIONE INLET	D MANDATA OUTLET	PESO WEIGHT kg
ISO 62	3.1.2.6.062.X.0.X.0	62	122	186	1" G	3/4" G	20.6
ISO 73	3.1.2.6.073.X.0.X.0	73	126	190	1" G	3/4" G	21.3
ISO 84	3.1.2.6.084.X.0.X.0	84	130	194	1" 1/4 G	1" G	22.0
ISO 100	3.1.2.6.100.X.0.X.0	100	130	200	1" 1/4 G	1" G	23.0
ISO 116	3.1.2.6.116.X.0.X.0	116	133	206	1" 1/4 G	1" G	24.0
ISO 132	3.1.2.6.132.X.0.X.0	132	137.5	212	1" 1/2 G	1" G	25.1
ISO 148	3.1.2.6.148.X.0.X.0	148	143.5	218	1" 1/2 G	1" G	26.2

MANICOTTO PER ACCOPPIAMENTO UNI 21-222  
COUPLING SLEEVE UNI 21-222

1.17.01.001.000

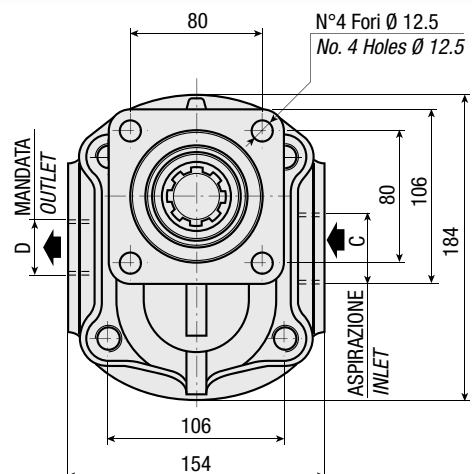
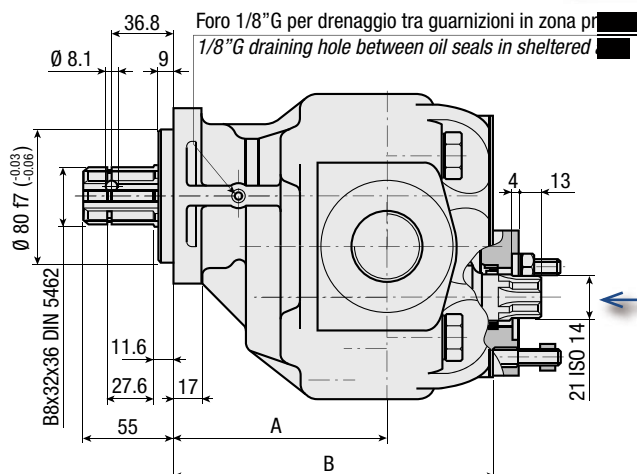

**DATI TECNICI - TECHNICAL DATA**

**ESEMPIO CICLI LAVORO - EXAMPLE OF WORKING CYCLES**

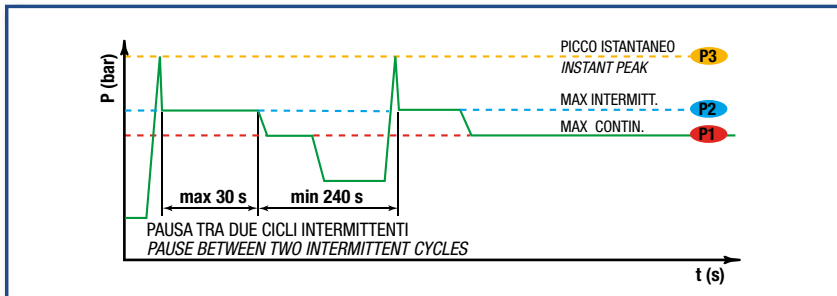

Pressione d'aspirazione: <i>Inlet pressure:</i>	0.7 ÷ 1.5 bar (assoluti/absolute)
Campo viscosità lavoro: <i>Operating viscosity range:</i>	12 ÷ 100 cSt
Temperatura fluido °C (t): <i>Fluid temperature °C (t):</i>	-10° + 80° C

Pressione Lavoro <i>Working Press.</i>	P2	Contaminazione - Contamination		Filtro - Filter $\beta_x = 75$
		NAS 1638	ISO 4406	
≤ 200 bar		12	21/18	40 μm
≥ 200 bar		11	20/17	25 μm

◀ **FILTRAZIONE CONSIGLIATA (ritorno o mandata)**  
**RECOMMENDED FILTERING (return or outlet)**

TIPO - TYPE			ISO 62	ISO 73	ISO 84	ISO 100	ISO 116	ISO 132	ISO 148
	Vg	cm <sup>3</sup> /n cm <sup>3</sup> /rev.	62	73	84	100	116	132	148
Cilindrata <i>Displacement</i>									
Pressione massima continua <i>Max continuous operating pressure</i>	P1		300	290	270	260	250	230	190
Pressione massima intermittente <i>Max intermitt. operating pressure</i>	(max 30 s)	P2	330	320	310	290	280	270	230
Pressione massima di picco <i>Max peak pressure</i>	(≤ 0.1 s)	P3	450	450	375	375	340	315	270
Velocità massima intermittente <i>Max intermittent speed</i>	(P ≤ 20 bar)	n3	3800	3800	3500	3500	3000	3000	3000
Velocità massima continua <i>Max continuous speed</i>	(≤ P1)	n1	2000	1800	1800	1500	1500	1500	1500
Velocità minima intermittente <i>Min intermittent speed</i>	(≤ P2 x 0.5) (max 30 s)	n4	400	300	300	250	250	250	250

**POTENZA ASSORBITA - ABSORBED POWER**

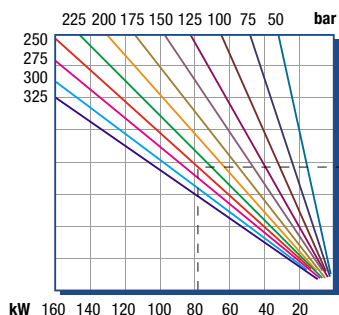

**PORTATA - CAPACITY**

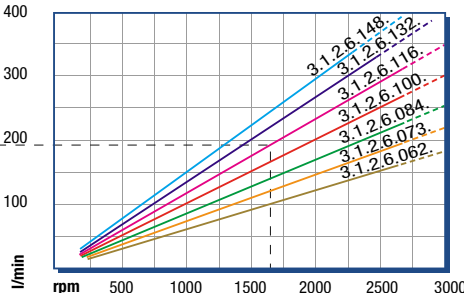

RILIEVI ESEGUITI CON OLIO  
ISO VG 46 A 50° C ( $\nu=30$  cSt)  
THE ABOVE SPECIFICATIONS  
REFER TO OIL TYPE ISO  
VG 46 AT 50° C ( $\nu=30$  cSt)

**DIAGRAMMI - DIAGRAMS**

**RENDIMENTO VOLUMETRICO - VOLUMETRIC EFFICIENCY**

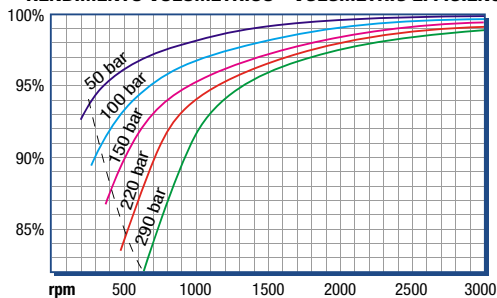

**COPPIA ASSORBITA - INPUT TORQUE**

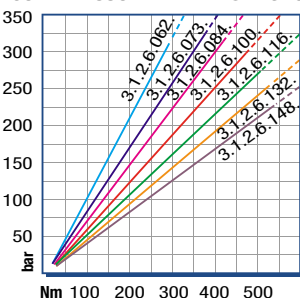



# SERIE **XP-4D** TANDEM **3.1.7.1.**

CODICE DI ORDINAZIONE - *DECODING*

**3.1.7.1 . XXX . X . 0 . 1 . 0**

**DIN**  
**5 4 6 2**  
**SE**

- XP-4D 15
- XP-4D 22
- XP-4D 36
- XP-4D 43
- XP-4D 57
- XP-4D 65
- XP-4D 83
- XP-4D 102

ALLESTIMENTI SPECIALI/SPECIAL OPTIONS  
1 = MONTAGGIO IN TANDEM/TANDEM FITTING

ROTAZIONE/ROTATION  
1 = SINISTRO/ANTICLOCKWISE  
2 = DESTRO/CLOCKWISE

CILINDRATA/DISPLACEMENT

CODICE BASE/BASIC CODE

## Pompa ad Ingranaggi *Gear Pump*



### CARATTERISTICHE E DATI TECNICI - SPECIFICATIONS AND TECHNICAL DATA

TIPO TYPE	CODICE CODE	CILINDRATA DISPLACEMENT cm <sup>3</sup> /rev.	A mm	B mm	C ASPIRAZIONE INLET	D MANDATA OUTLET	PESO WEIGHT kg
XP-4D 15	3.1.7.1.015.X.0.1.0	15	102	167	3/4" G	3/4" G	10
XP-4D 22	3.1.7.1.022.X.0.1.0	22	102	172	3/4" G	3/4" G	10.5
XP-4D 36	3.1.7.1.036.X.0.1.0	36	107	182	1" G	1" G	11.4
XP-4D 43	3.1.7.1.043.X.0.1.0	43	107	187	1" G	1" G	11.9
XP-4D 57	3.1.7.1.057.X.0.1.0	57	117	197	1" G	1" G	12.8
XP-4D 65	3.1.7.1.065.X.0.1.0	65	117	202	1" G	1" G	13.2
XP-4D 83	3.1.7.1.083.X.0.1.0	83	117	217	1" 1/4 G	1" G	14.5
XP-4D 102	3.1.7.1.102.X.0.1.0	102	117	229	1" 1/4 G	1" G	15.5

#### KIT ACCOPPIAMENTO POSTERIORE *REAR MOUNTING KIT*

2.05.P002.0000

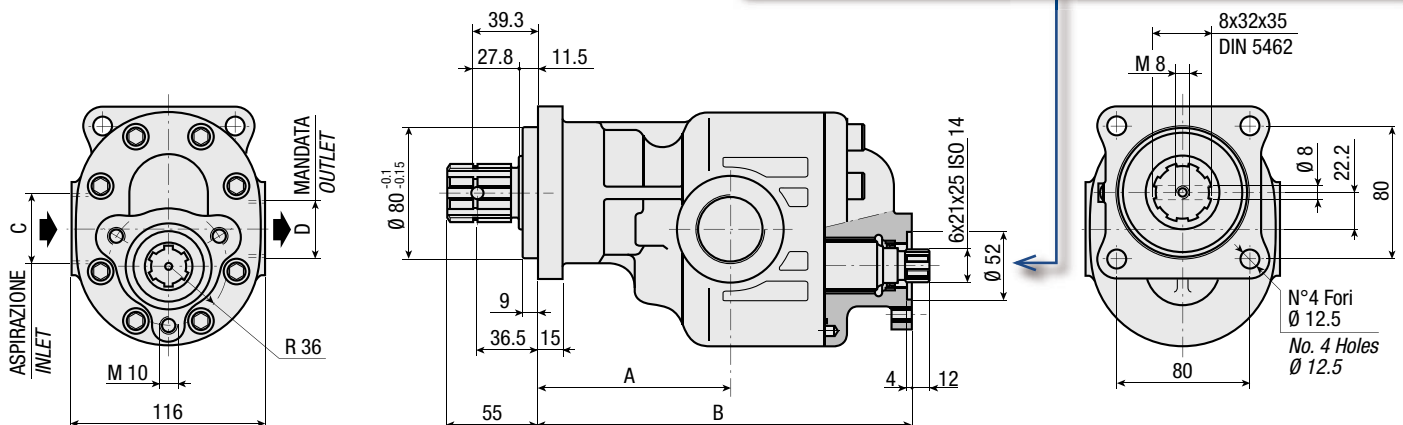



**DATI TECNICI - TECHNICAL DATA**

**ESEMPIO CICLI LAVORO - EXAMPLE OF WORKING CYCLES**

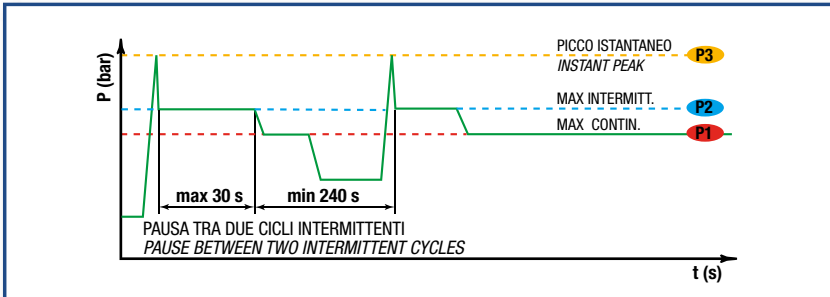

Pressione d'aspirazione: <i>Inlet pressure:</i>	0.7 ÷ 1.5 bar (assoluti/absolute)
Campo viscosità lavoro: <i>Operating viscosity range:</i>	12 ÷ 100 cSt
Temperatura fluido °C (t): <i>Fluid temperature °C (t):</i>	-10° + 80° C

Pressione Lavoro <i>Working Press.</i>	P2	Contaminazione - Contamination		Filtro - Filter $\beta_x = 75$
		NAS 1638	ISO 4406	
≤ 200 bar		12	21/18	40 μm
≥ 200 bar		11	20/17	25 μm

◀ **FILTRAZIONE CONSIGLIATA (ritorno o mandata)**  
**RECOMMENDED FILTERING (return or outlet)**

TIPO - TYPE			XP-4D 15	XP-4D 22	XP-4D 36	XP-4D 43	XP-4D 57	XP-4D 65	XP-4D 83	XP-4D 102
Cilindrata <i>Displacement</i>	Vg	cm <sup>3</sup> /n cm <sup>3</sup> /rev.	15	22	36	43	57	65	84	102
Pressione massima continua <i>Max continuous operating pressure</i>	P1	bar	315	305	300	280	260	240	220	180
Pressione massima intermittente <i>Max intermitt. operating pressure</i> (max 30 s)	P2		340	330	325	305	285	265	240	200
Pressione massima di picco <i>Max peak pressure</i> (≤ 0.1 s)	P3		450	450	450	400	380	330	300	250
Velocità massima intermittente <i>Max intermittent speed</i> (P ≤ 20 bar)	n3	n/min r.p.m.	3000	3000	3000	3000	3000	3000	3000	2500
Velocità massima continua <i>Max continuous speed</i> (≤ P1)	n1		2500	2500	2500	2500	2500	2500	2500	2000
Velocità minima intermittente <i>Min intermittent speed</i> (≤ P2 x 0.5) (max 30 s)	n4		500	500	450	450	450	400	400	400

**POTENZA ASSORBITA - ABSORBED POWER**

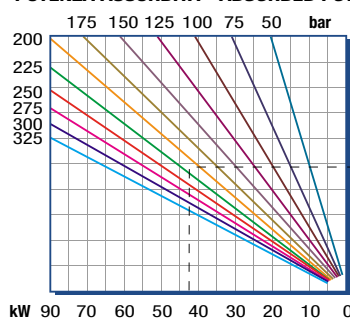

**PORTATA - CAPACITY**

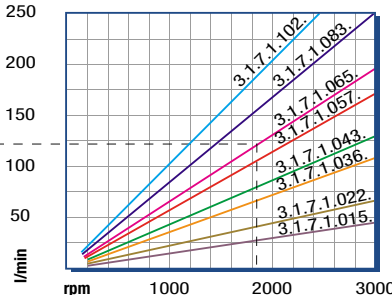

RILIEVI ESEGUITI CON OLIO  
ISO VG 46 A 50° C ( $\nu=30$  cSt)  
THE ABOVE SPECIFICATIONS  
REFER TO OIL TYPE ISO  
VG 46 AT 50° C ( $\nu=30$  cSt)

**DIAGRAMMI - DIAGRAMS**

**RENDIMENTO VOLUMETRICO - VOLUMETRIC EFFICIENCY**

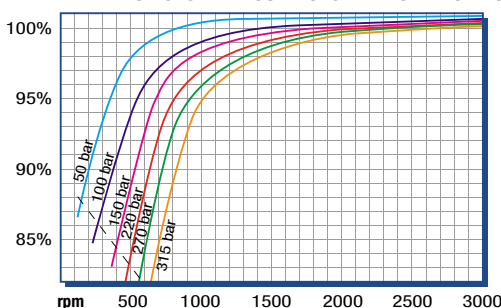

**COPPIA ASSORBITA - INPUT TORQUE**

